

REVISIONS		DATE
IR	INITIAL RELEASE	6/15/2009
A	UPDATE TITLE BLOCK	11/21/2014

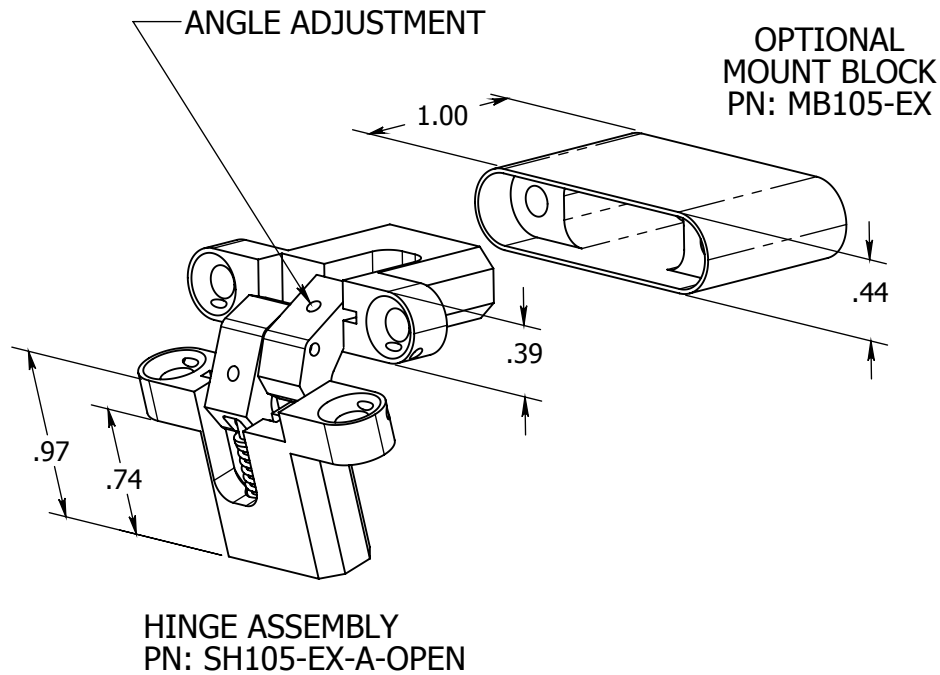

NOTES:

1. USE WITH LIGHTWEIGHT PANELS ONLY
2. DO NOT OPEN PANEL GREATER THAN THE ADJUSTED TRAVEL
3. INSTALL USING NAS514P832 SCREW (4X) OR EQUIV.
4. MAXIMUM OPEN ANGLE 105 DEGREES.
5. MAX RANGE OF ADJUSTMENT: 75 TO 105 DEGREES.
6. STANDARD FINISH: BLACK ANODIZE
7. OPTIONAL FINISH: CLEAR ANODIZE
8. USE 0.035" HEX DRIVER TO REDUCE OPEN ANGLE
9. MINIMUM PANEL THICKNESS 0.50"

<p>PROPRIETARY AND CONFIDENTIAL</p> <p>THE INFORMATION CONTAINED IN THIS DRAWING IS THE SOLE PROPERTY OF SAINT LOUIS DESIGNS. ANY REPRODUCTION IN PART OR AS A WHOLE WITHOUT THE WRITTEN PERMISSION OF SAINT LOUIS DESIGNS IS PROHIBITED.</p>		<p>UNLESS SPECIFIED OTHERWISE DIMENSIONS ARE IN INCHES</p> <p>TOLERANCES:</p> <p>ANGULAR: $\pm 1^\circ$</p> <p>TWO PLACE DECIMAL ± 0.01</p> <p>THREE PLACE DECIMAL ± 0.005</p> <p>SURFACE FINISH: 32 RMA</p>	NAME	DATE	<p>Saint Louis Designs, Inc.</p> <p>PO BOX 3400, Austin, TX78764</p> <p>512-472-4711, www.saintlouisdesigns.com</p>						
			DRAWN	MSTL		6/15/2009					
			CHECKED								
			ENG APPR.								
			MFG APPR.	MSTL		6/15/2009					
		MATERIAL	7075-T651		<p>SPRING HINGE, ADJUSTABLE</p>						
			QQ-A-225/9								
		FINISH	SEE NOTES 6 & 7								
	DEBUR AND BREAK SHARP EDGES				<table border="1" style="width: 100%;"> <tr> <td>SIZE</td> <td>DWG. NO.</td> <td>REV.</td> </tr> <tr> <td>A</td> <td>SH105-EX-A-OPEN</td> <td>A</td> </tr> </table>	SIZE	DWG. NO.	REV.	A	SH105-EX-A-OPEN	A
SIZE	DWG. NO.	REV.									
A	SH105-EX-A-OPEN	A									
		DO NOT SCALE DRAWING			<table border="1" style="width: 100%;"> <tr> <td>SCALE: 1:1</td> <td>WEIGHT:</td> <td>SHEET 1 OF 1</td> </tr> </table>	SCALE: 1:1	WEIGHT:	SHEET 1 OF 1			
SCALE: 1:1	WEIGHT:	SHEET 1 OF 1									