

1

2

3

4

THE INFORMATION CONTAINED IN THIS DRAWING IS THE SOLE PROPERTY OF Saint Louis Designs, Inc. ANY REPRODUCTION IN PART OR WHOLE WITHOUT THE WRITTEN PERMISSION OF Saint Louis Designs, Inc. IS PROHIBITED.

REVISIONS		DATE
IR	INITIAL RELEASE	6/15/2009
A	EDITED TITLE BLOCK	10/7/2014
B	EDITED NOTES	10/8/2014

A

B

C

D

E

F

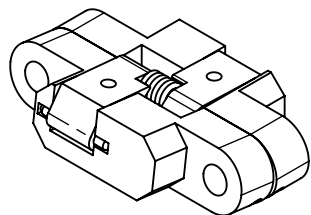
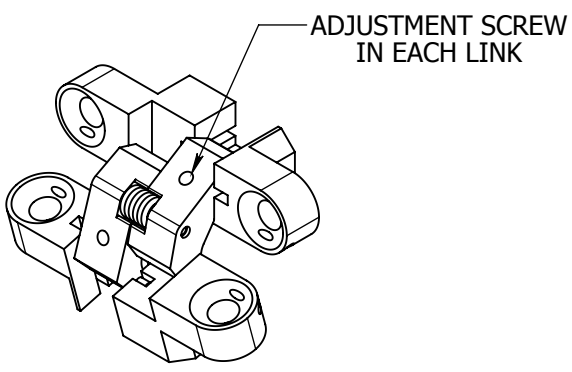
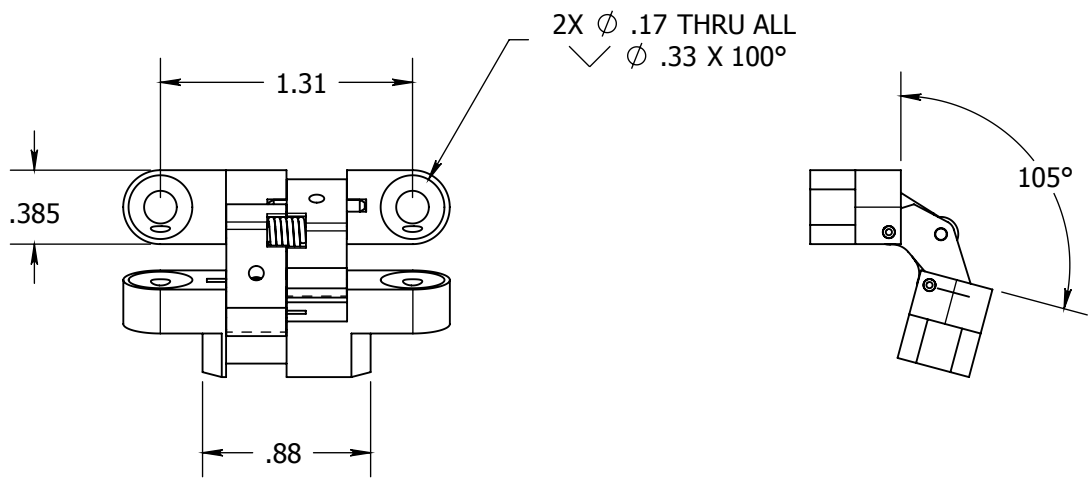

PN: SH105-A-OPEN

PN: SH105-A-CLOSE

NOTES:

1. USE THE -OPEN MODEL WHERE FORCE WANTED IN THE OPEN DIRECTION
2. USE THE -CLOSE MODEL FOR SELF CLOSING HINGE.
3. INSTALL USING NAS514P832 SCREW (4X) OR EQUIV.
4. MAXIMUM OPEN ANGLE 105 DEGREES FOR BOTH -CLOSE & -OPEN.
5. MAX RANGE OF ADJUSTMENT: 75 TO 105 DEGREES.
6. STANDARD FINISH: BLACK ANODIZE
7. OPTIONAL FINISH: CLEAR ANODIZE
8. USE 0.035" HEX DRIVER TO REDUCE OPEN ANGLE
9. MINIMUM PANEL THICKNESS 0.50"

UNLESS OTHERWISE SPECIFIED:
 DIMENSIONS ARE IN INCHES
 SURFACE FINISH: 32 RMA
 TOLERANCES: LINEAR:
 X.XX= ±0.010", X.XXX= ±0.005"
 ANGULAR: ±1°

FINISH:
 SEE NOTES: 6 & 7

DEBUR AND
 BREAK SHARP
 EDGES

Saint Louis Designs, Inc

PO BOX 3400, Austin, TX 78764
 512-472-4711, www.saintlouisdsgns.com

NAME	SIGNATURE	DATE	MATERIAL:
DRAWN MSTL		6/2009	AI 7075-T6
CHK'D			
APPV'D			
MFG			
Q.A			
			WEIGHT: 0.04

TITLE: SPRING LOADED HINGE ADJUSTABLE, SPECIFY OPEN OR CLOSE	DWG NO. SH105-A
SCALE: 1:1	SHEET 1 OF 1