

REVISIONS		DATE
IR	INITIAL RELEASE	10/2010
A	EDIT NOTES & TITLE BLOCK	7/22/2014

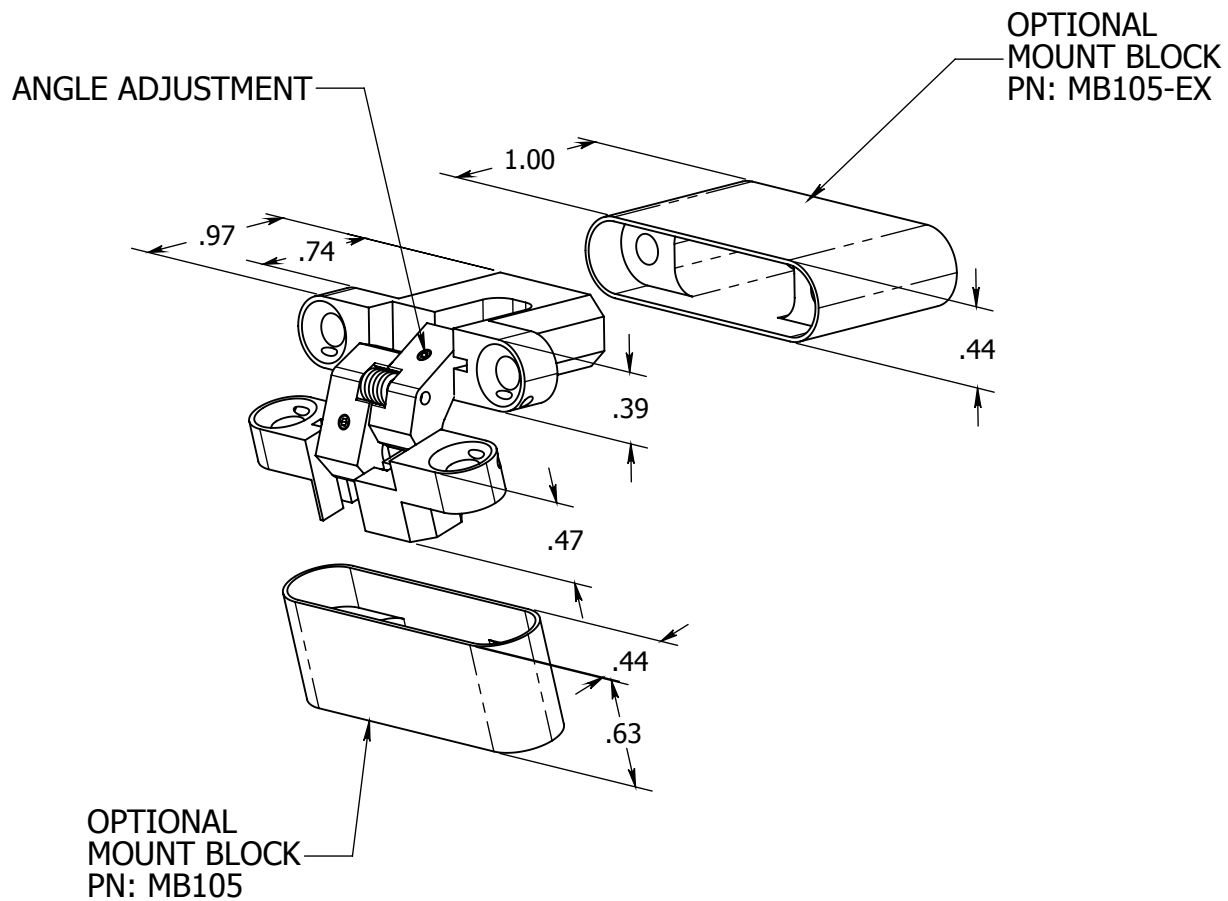

#### NOTES:

1. USE WITH LIGHTWEIGHT PANELS ONLY
2. DO NOT OPEN PANEL GREATER THAN THE ADJUSTED TRAVEL
3. INSTALL USING NAS514P832 SCREW (4X) OR EQUIV.
4. STANDARD FINISH: BLACK ANODIZE
5. OPTIONAL FINISH: CLEAR ANODIZE
6. USE 0.035" HEX DRIVER TO REDUCE OPEN ANGLE
7. MINIMUM PANEL THICKNESS 0.50"

<div>PROPRIETARY AND CONFIDENTIAL</div> <div>THE INFORMATION CONTAINED IN THIS DRAWING IS THE SOLE PROPERTY OF SAINT LOUIS DESIGNS. ANY REPRODUCTION IN PART OR AS A WHOLE WITHOUT THE WRITTEN PERMISSION OF SAINT LOUIS DESIGNS IS PROHIBITED.</div>		<div>UNLESS SPECIFIED OTHERWISE DIMENSIONS ARE IN INCHES</div> <div>TOLERANCES:</div> <div>ANGULAR: ±1°</div> <div>TWO PLACE DECIMAL ±0.01</div> <div>THREE PLACE DECIMAL ±0.005</div> <div>SURFACE FINISH: 32 RMA</div> <div>MATERIAL 7075-T651</div> <div>QQ-A-225/8</div> <div>FINISH SEE NOTES</div> <div>DO NOT SCALE DRAWING</div>	<div>NAME</div> <div>DATE</div>		<div>Saint Louis Designs, Inc.</div> <div>PO BOX 3400, Austin, TX78764</div> <div>512-472-4711, www.saintlouisdesigns.com</div>			
			<div>DRAWN</div> <div>MSTL</div> <div>7/22/2014</div>					
			<div>CHECKED</div> <div></div> <div></div>					
			<div>ENG APPR.</div> <div></div> <div></div>					
			<div>MFG APPR.</div> <div>MSTL</div> <div>7/22/2014</div>					
		<div>Q.A.</div> <div></div> <div></div>			<div>SIZE DWG. NO. REV.</div> <div>A SH105-MIX A</div> <div>SCALE:1:1 WEIGHT: SHEET 1 OF 1</div>			
		<div>COMMENTS:</div>						
	<div>DEBUR AND BREAK SHARP EDGES</div>							