

REVISIONS		DATE
IR	INITIAL RELEASE	04152002
A	EDITED NOTES & TITLE BLOCK	08262015
B	TITLE BLOCK CORRECTIONS	01222017

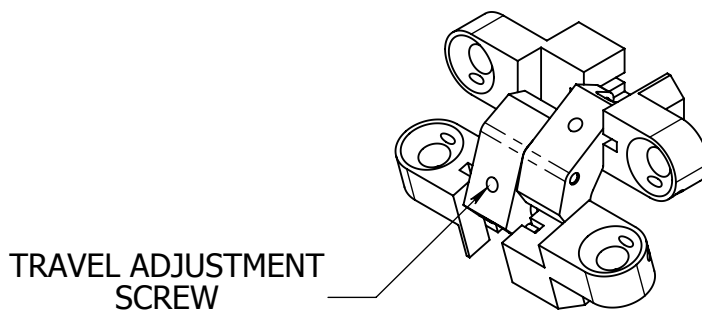
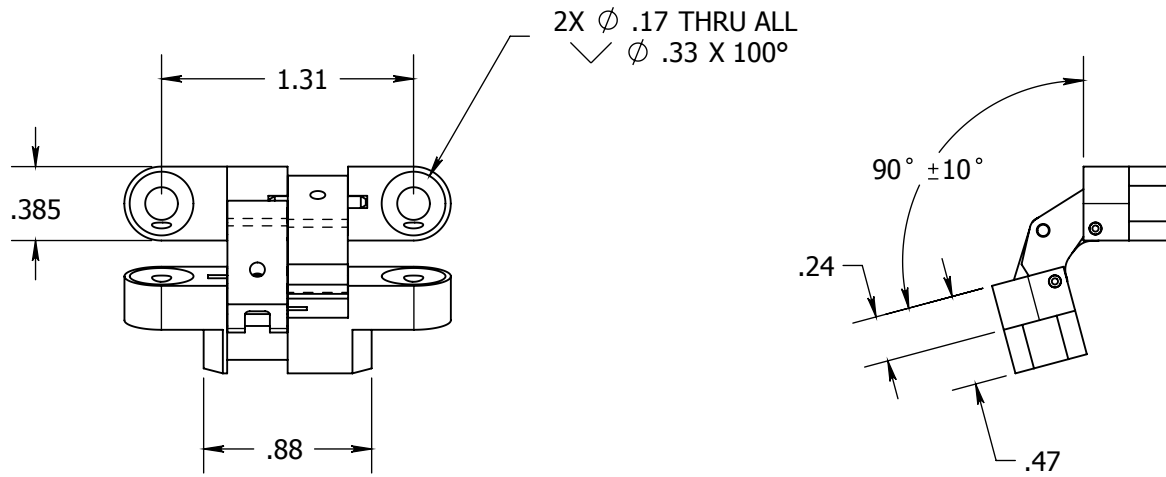

**NOTES:**

1. INSTALL USING NAS514P832 SCREW (4X) OR EQUIV.
2. STANDARD FINISH: BLACK ANODIZE
3. OPTIONAL FINISH: CLEAR ANODIZE
4. USE 0.035" HEX DRIVER TO REDUCE OPEN ANGLE
5. MINIMUM PANEL THICKNESS 0.50"

<p><b>PROPRIETARY AND CONFIDENTIAL</b></p> <p>THE INFORMATION CONTAINED IN THIS DRAWING IS THE SOLE PROPERTY OF SAINT LOUIS DESIGNS. ANY REPRODUCTION IN PART OR AS A WHOLE WITHOUT THE WRITTEN PERMISSION OF SAINT LOUIS DESIGNS IS PROHIBITED.</p>		<p>UNLESS SPECIFIED OTHERWISE DIMENSIONS ARE IN INCHES</p> <p>TOLERANCES:</p> <p>ANGULAR: ±1°</p> <p>TWO PLACE DECIMAL ±0.01</p> <p>THREE PLACE DECIMAL ±0.005</p> <p>SURFACE FINISH: 32 RMA</p>	NAME	DATE	<p><b>Saint Louis Designs, Inc.</b></p> <p>PO BOX 3400, Austin, TX78764</p> <p>512-472-4711, www.saintlouisdesigns.com</p>	
			DRAWN	MSTL		07222014
			CHECKED			
			ENG APPR.			
		MATERIAL	7075-T651	Q-Q-A-225/8		
		FINISH	SEE NOTES			
		DO NOT SCALE DRAWING				
	DEBUR AND BREAK SHARP EDGES	COMMENTS:				
		SIZE	DWG. NO.	H105-A	REV. B	
		SCALE: 1:1	WEIGHT: 0.04	SHEET 1 OF 1		