

REVISIONS		DATE
IR	INITIAL RELEASE	2/14/2002
A	CHANGED MOUNT HOLE LOCATIONS	3/19/2002
B	UPDATED TITLE BLOCK	11/13/2012

NOTES:

1. INSTALL USING FOUR (4) NAS514832 SCREWS OR EQUIV.
2. MOUNT PLATE IS REVERSIBLE.
3. NO BACK CLEARANCE IS REQUIRED FOR INSTALLATION.
4. 5Lbs FORCE = 20150MP-5
5. 10Lbs FORCE = 20150MP-10, ** EXTENSION IS REDUCED TO 0.70"

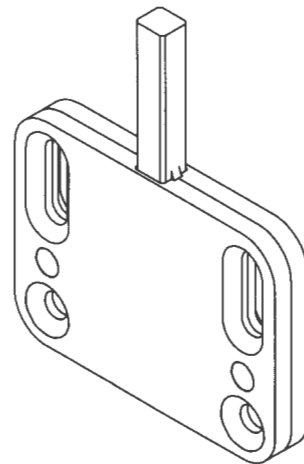
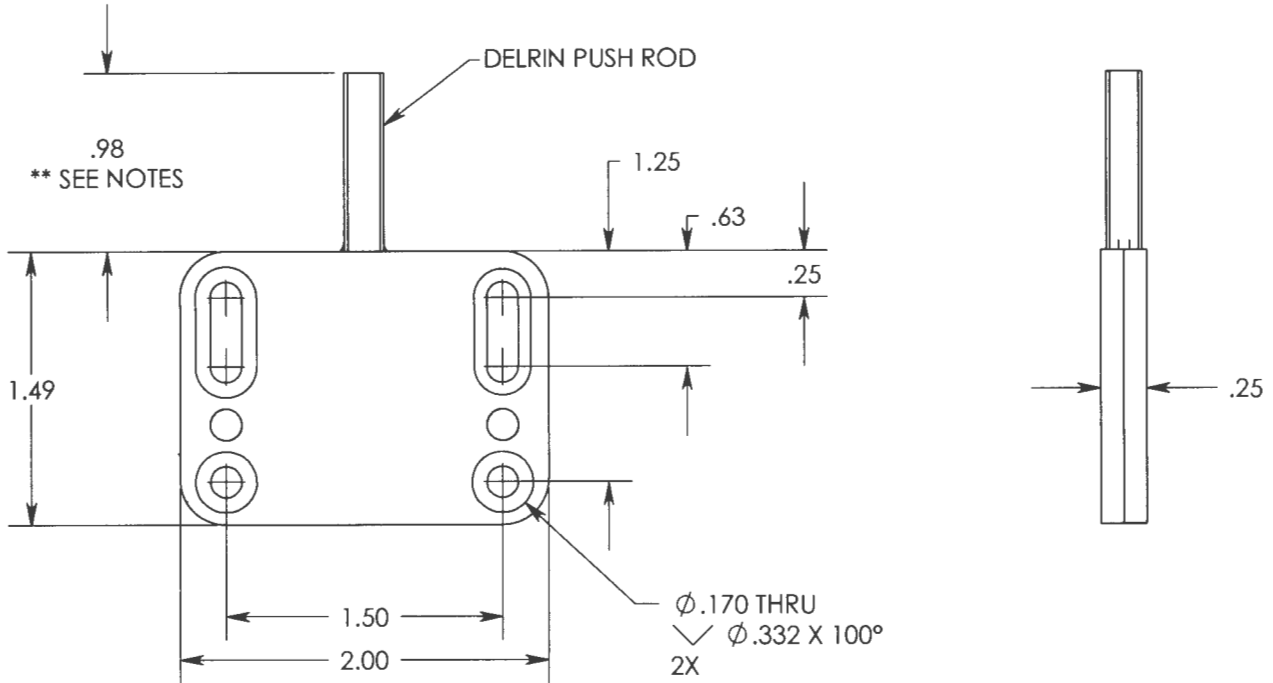

<p>PROPRIETARY AND CONFIDENTIAL THE INFORMATION CONTAINED IN THIS DRAWING IS THE SOLE PROPERTY OF SAINT LOUIS DESIGNS. ANY REPRODUCTION IN PART OR AS A WHOLE WITHOUT THE WRITTEN PERMISSION OF SAINT LOUIS DESIGNS IS PROHIBITED.</p>		UNLESS SPECIFIED OTHERWISE DIMENSIONS ARE IN INCHES TOLERANCES: ANGULAR: ±1° TWO PLACE DECIMAL ±0.01 THREE PLACE DECIMAL ±0.005 SURFACE FINISH: 32 RMA	NAME	DATE	<p>Saint Louis Designs, Inc. 11417 FM 1625, Creedmoor, TX 78610 512-472-4711, www.saintlouisdesigns.com</p>		
		MATERIAL	DRAWN	MSTL		2/2002	
		6061-T651, QQ-A-200/8	CHECKED	<i>CT</i>		11/2012	
		FINISH	ENG APPR.			<p>PUSHER, MOUNTED</p>	
		BLACK ANODIZE MIL-A-8625F, TYPE 2 CLASS 2	MFG APPR.	MSTL	11/2012		
		DO NOT SCALE DRAWING	Q.A.				
	DEBUR AND BREAK SHARP EDGES	COMMENTS:			SIZE	DWG. NO.	REV.
					A	20150MP-XX	B
					SCALE: 1:1	WEIGHT:	SHEET 1 OF 1